

4 conductor ribbon cable
1.5m length

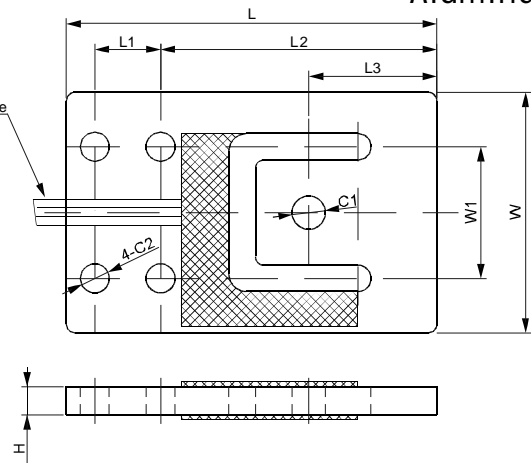

Aluminum

PLANARS

CE RoHS

DIMENSIONS

RATED CAPACITY	C1	C2	H	L	L1	L2	L3	W	W1
kg/mm									
3.75	5.1 DIA	5.1 DIA	2.0	70.0	14.0	51.1	23.1	39.0	27.8
7.5	5.1 DIA	5.1 DIA	2.5	70.0	14.0	51.1	23.1	39.0	27.8
15	7.6 DIA	5.1 DIA	4.1	70.0	14.0	51.1	23.1	39.0	27.8
37.5	7.6 DIA	6.6 DIA	4.8	76.2	15.0	55.2	25.9	44.5	30.0
75	7.6 DIA	6.6 DIA	6.4	84.4	15.0	63.0	29.0	54.8	30.0
150	9.1 DIA	8.1 DIA	7.9	107.3	22.9	76.6	30.7	69.9	44.5
375	9.1 DIA	9.8 DIA	12.7	119.4	25.4	84.9	32.3	76.1	50.8
lb/inches (conversion of above dimensions)									
8.27	0.20 DIA	0.20 DIA	0.08	2.76	0.55	2.01	0.91	1.54	1.10
16.5	0.20 DIA	0.20 DIA	0.10	2.76	0.55	2.01	0.91	1.54	1.10
33	0.30 DIA	0.20 DIA	0.16	2.76	0.55	2.01	0.91	1.54	1.10
82.7	0.30 DIA	0.26 DIA	0.19	3.00	0.59	2.17	1.02	1.75	1.18
165	0.30 DIA	0.26 DIA	0.25	3.32	0.59	2.48	1.14	2.16	1.18
331	0.36 DIA	0.32 DIA	0.31	4.22	0.90	3.02	1.21	2.75	1.75
827	0.36 DIA	0.39 DIA	0.50	4.70	1.00	3.34	1.27	3.00	2.00

SPECIFICATIONS

Rated Capacity	kg	3.75; 7.5; 15; 37.5	75	150; 375
Weight (G), approx.	kg/lb	-	0.1 / 0.2	-
Full Scale Output	mV/V	0.9 ± 0.1%		
Zero Balance	mV/V	± 0.3		
Non-linearity	%	< ± 0.020		
Repeatability	%	< ± 0.017		
Hysteresis error	%	< ± 0.015		
Creep in 30 min.	%	< ± 0.015		
Bridge Resistance	Ω	1000 ± 10		
Rated Excitation	V(DC/AC)	10 (15V Maximum)		
Insulation Resistance	GΩ	>1 [50 VDC]		
Nominal Temperature Range	°C/°F	-10 to 40 / 14 to 104		
Safe Overload	% of full scale	150		
Breaking Overload	% of full scale	300		
Seal Type		Environmentally-sealed, IP65		

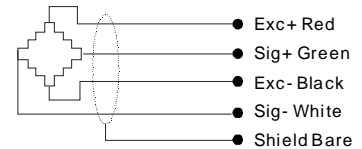

INTERCHANGEABLE PRODUCTS

Manufacturer	Model
FLINTEC.....	PB
Rice Lake.....	RL BLP